

LF 25 Pressure Switch

LF25 pressure switch is to control the pressure of application with higher current capacity. It is widely used in steam cleaner, steam iron and other pressure control system. It provides SPST or SPDT contact form and switch deadband (also referred to as mechanical differential or hysteresis).

LF25 switch utilize high-quality miniature snap-action switches. The switch is diaphragm operated. Diaphragm material can be selected for the operating medium, temperature range and other parameters. During the development of a specification, actuation point can be adjusted by the designer, In production, factory setting is required.



Specification

Model	LF25					
Media	Non hazardous gas, liquid or steam					
Operating Pressure	0.2-0.6bar	0.5-1.5bar	1.2-2.5bar	2.0-4.0bar	3.0-7.0bar	5.0-9.0bar
Proof Pressure	3bar	4bar	5bar	6bar	8bar	10bar
Differential	0.2±0.1bar	0.2±0.1bar	0.2±0.1bar	0.25±0.15bar	0.3±0.15bar	0.35±0.15bar
Operating Temperature Range	+125℃ Maximum					
Contact Arrangement	SPST or SPDT					
Electrical Rating	SPST or SPDT/Normal Close: 16 (4) -250VAC Other ratings are available on request					
Terminals	6.3 or 4.8mm male Q.C. Insulation cover is available if necessary					
Connection	1/8NPT-27 or 1/4NPT-18 male Other connection is optional					

Conversion: 1Kg/cm²=14.2PSI 1Bar=14.5PSI

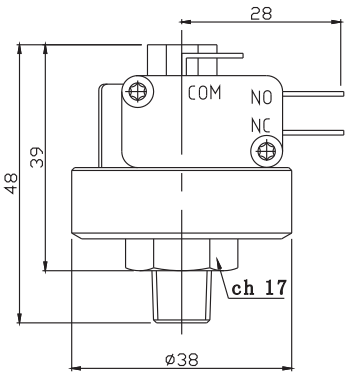
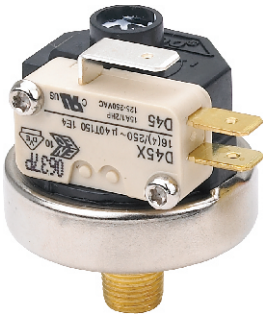

LF 25 Order Ref No:

i.e.: LF25-4111-3.5Bar

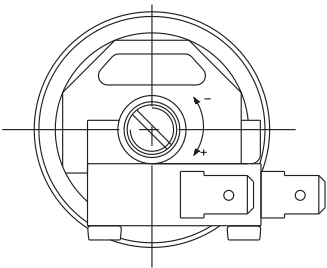
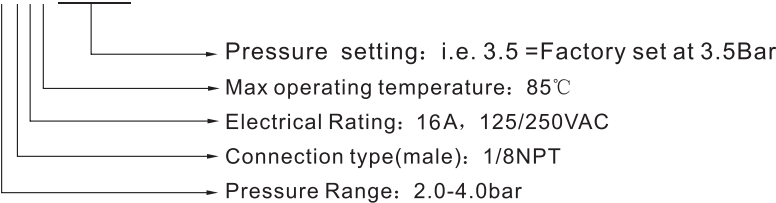

尺寸单位: mm
(Dimension in mm)

Number	Pressure Range	Connection type (male)	Electrical Rating	Max operating temperature
0	/	/	/	/
1	0.2-0.6 bar	1/8NPT	16A,125-250VAC	85℃
2	0.5-1.5 bar	G1/8	21A,125-250VAC	125℃
3	1.2-2.5 bar	R1/8	/	/
4	2.0-4.0 bar	1/4NPT	/	/
5	3.0-7.0 bar	G1/4	/	/
6	5.0-9.0 bar	R1/4	/	/